

# Single Family Residence For sale

- 1928 Montgomery, Celina, Texas 75009

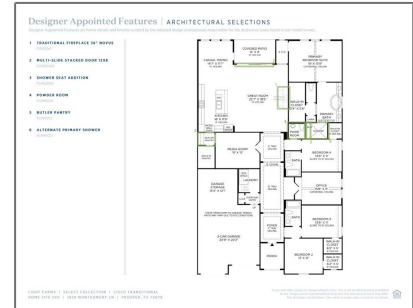

## Basic Details

Property Type: **Single Family Residence**

Listing Type: **For sale**

MLS Number: **20776221**

Price: **\$974,960**

Bedrooms: **4**

Bathrooms: **4**

Half Bathrooms: **1**

Year Built: **2025**

Acreage: **0.21 Acre**

## Address Map

Country: **USA**

State: **TX**

County: **Collin**

City: **Celina**

Subdivision: **Light Farms Select**

Zipcode: **75009**

Street: **Montgomery**

Street Number: **1928**

## Features

✓ Heating System: **Central, Zoned**

✓ Fence: **Wood**

✓ Security: **Fire Alarm**

## Additional Info

✓ Utilities: **City water, City sewer, Individual water meter, Individual gas meter, Community mailbox**

✓ Architectural Style: **Traditional, Other**

Association Fee: **\$132**

Association Fee Frequency: **Monthly**

✓ Community Features: **Club house, Community**

Floor Number:	<b>0</b>
Longitude:	<b>W97° 11' 13.5"</b>
Latitude:	<b>N33° 15' 54.3"</b>

pool, Other, Park, Community dock, Playground, Greenbelt, Jogging path/bike path, Fitness Center, Curbs, Lake, Community Sprinkler, Tennis Court(s), Electric Car Charging Station, Pool, Sidewalks, Fishing, Restaurant, Pickle Ball Court

Elementary School Name: **Ralph and mary lynn boyer**

✓ Exterior Features: Covered Patio/porch, Rain Gutters

✓ Interior Features: Cable tv available, Decorative lighting, Flat screen wiring, High speed internet available, Built-in Features, Eat-in Kitchen, Kitchen Island, Walk-in Closet(s), Open Floorplan

High School Name: **Prosper**

List Agent Full Name: **Danielle Durbin**

List Office Name: **SevenHaus Realty**

✓ Lot Features: Subdivision, Interior lot, Landscaped, Lrg. backyard grass, Corner Lot, Few Trees, Sprinkler System

Matrix Modified DT:

Middle School Name: **Reynolds**

Parcel Number: **111111**

✓ Parking Features: Garage, Garage door opener, Garage Faces Front, Tandem

School District: **Prosper isd**

Property Type: **Residential**

✓ Roof: Composition

Status:	<b>Active</b>
Structural Style:	<b>Single detached</b>
SQFT Gross:	<b>0 Sqft</b>
SQFT Lot:	<b>9,060.48 Sqft</b>
Street Suffix:	<b>Lane</b>
✓ Fireplace Features:	<b>Gas starter</b>
Number Of Parking Spaces:	<b>0</b>
Fireplace:	<b>1</b>
Garage:	<b>0</b>

## Agent Info

---



Pam Matlock

 <http://pammatlock.com/>

 469-269-0PAM

 pam@pammatlock

---