

Single Family Residence For sale

- 224 Saddle Blanket, Josephine, Texas 75173

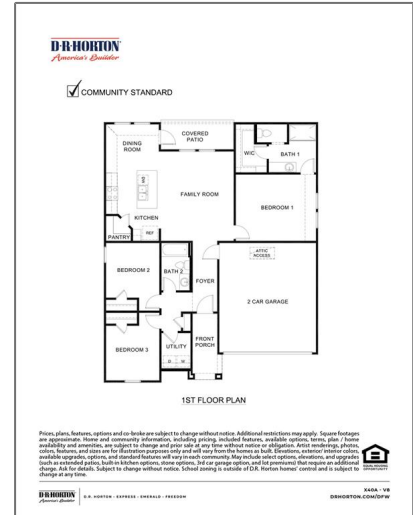

Basic Details

Property Type:	Single Family Residence
Listing Type:	For sale
MLS Number:	20776007
Price:	\$266,990
Bedrooms:	3
Bathrooms:	2
Year Built:	2025
Acreage:	0.17 Acre

Address Map

Country:	USA
State:	TX
County:	Collin
City:	Josephine
Subdivision:	Waverly Estates
Zipcode:	75173

Features

<input checked="" type="checkbox"/>	Heating System:	Central, Electric
<input checked="" type="checkbox"/>	Fence:	Wood
<input checked="" type="checkbox"/>	Security:	Smoke Detector(s), Carbon Monoxide Detector(s)

Additional Info

<input checked="" type="checkbox"/>	Utilities:	City water, City sewer
<input checked="" type="checkbox"/>	Architectural Style:	Traditional

Association Fee:	\$550
Association Fee Frequency:	Semi-Annual

Street:	Saddle Blanket
Street Number:	224
Floor Number:	0
Longitude:	W97° 41' 8.7"
Latitude:	N33° 2' 59.4"

Elementary School Name: **Mcclendon**

✓ Interior Features: **Cable tv available, Decorative lighting, High speed internet available, Eat-in Kitchen, Kitchen Island, Pantry, Granite Counters, Open Floorplan**

✓ Flooring: **Carpet, Laminate**

High School Name: **Community**

List Agent Full Name: **Bryan Reasor**

List Office Name: **Jeanette Anderson Real Estate**

Matrix Modified DT:

Middle School Name: **Leland Edge**

Parcel Number: **2890941**

✓ Parking Features: **Garage**

School District: **Community Isd**

Property Type: **Residential**

✓ Roof: **Composition**

Status: **Active**

Structural Style: **Single detached**

SQFT Gross: **0 Sqft**

SQFT Lot: **7,405.20 Sqft**

Street Suffix: **Drive**

Number Of Parking Spaces: **0**

Fireplace: **0**

Garage: **0**



Pam Matlock

 <http://pammatlock.com/>

 469-269-0PAM

 pam@pammatlock

