

# Single Family Residence For sale

- 1206 Sideboard, Josephine, Texas 75173

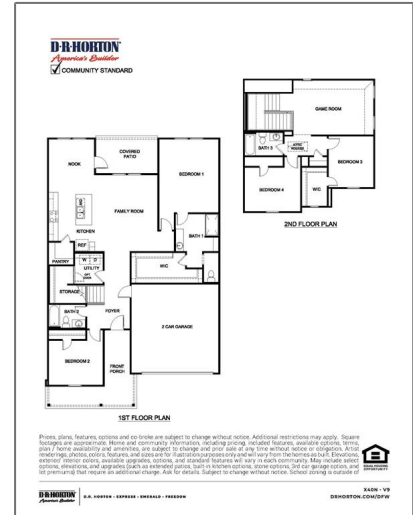

## Basic Details

Property Type:	<b>Single Family Residence</b>
Listing Type:	<b>For sale</b>
MLS Number:	<b>20742631</b>
Price:	<b>\$322,490</b>
Bedrooms:	<b>4</b>
Bathrooms:	<b>3</b>
Year Built:	<b>2024</b>
Acreage:	<b>0.19 Acre</b>

## Address Map

Country:	<b>USA</b>
State:	<b>TX</b>
County:	<b>Collin</b>
City:	<b>Josephine</b>
Subdivision:	<b>Waverly Estates</b>
Zipcode:	<b>75173</b>

## Features

<input checked="" type="checkbox"/>	Heating System:	<b>Central, Natural Gas</b>
<input checked="" type="checkbox"/>	Fence:	<b>Wood</b>
<input checked="" type="checkbox"/>	Security:	<b>Smoke Detector(s), Carbon Monoxide Detector(s)</b>

## Additional Info

<input checked="" type="checkbox"/>	Utilities:	<b>City water, City sewer</b>
<input checked="" type="checkbox"/>	Architectural Style:	<b>Traditional</b>

Association Fee:	<b>\$275</b>
Association Fee Frequency:	<b>Semi-Annual</b>

Street:	<b>Sideboard</b>
Street Number:	<b>1206</b>
Floor Number:	<b>0</b>
Longitude:	<b>W97° 41' 8.5"</b>
Latitude:	<b>N33° 2' 53.6"</b>

✓ Interior Features:	<b>Cable tv available, Decorative lighting, High speed internet available, Eat-in Kitchen, Kitchen Island, Pantry, Granite Counters, Open Floorplan</b>
----------------------	---

✓ Flooring:	<b>Carpet, Laminate</b>
-------------	-------------------------

High School Name:	<b>Community</b>
-------------------	------------------

List Agent Full Name:	<b>Bryan Reasor</b>
-----------------------	---------------------

List Office Name:	<b>Jeanette Anderson Real Estate</b>
-------------------	--------------------------------------

Matrix Modified DT:	
---------------------	--

Middle School Name:	<b>Leland Edge</b>
---------------------	--------------------

Parcel Number:	<b>2891117</b>
----------------	----------------

✓ Parking Features:	<b>Garage</b>
---------------------	---------------

School District:	<b>Community Isd</b>
------------------	----------------------

Property Type:	<b>Residential</b>
----------------	--------------------

✓ Roof:	<b>Composition</b>
---------	--------------------

Status:	<b>Active</b>
---------	---------------

Structural Style:	<b>Single detached</b>
-------------------	------------------------

SQFT Gross:	<b>0 Sqft</b>
-------------	---------------

SQFT Lot:	<b>8,450.64 Sqft</b>
-----------	----------------------

Street Suffix:	<b>Drive</b>
----------------	--------------

Number Of Parking Spaces:	<b>0</b>
---------------------------	----------

Fireplace:	<b>0</b>
------------	----------

Garage:	<b>0</b>
---------	----------

Agent [Info](#)

---



Pam Matlock

 <http://pammatlock.com/>

 469-269-0PAM

 pam@pammatlock

