

# Single Family Residence For sale

- 1211 Burlap, Josephine, Texas 75173

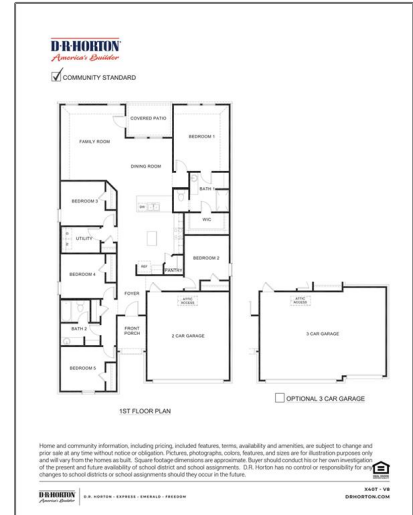

## Basic Details

Property Type:	<b>Single Family Residence</b>
Listing Type:	<b>For sale</b>
MLS Number:	<b>20718422</b>
Price:	<b>\$301,990</b>
Bedrooms:	<b>5</b>
Bathrooms:	<b>2</b>
Year Built:	<b>2024</b>
Acreage:	<b>0.17 Acre</b>

## Address Map

Country:	<b>USA</b>
State:	<b>TX</b>
County:	<b>Collin</b>
City:	<b>Josephine</b>
Subdivision:	<b>Waverly Estates</b>
Zipcode:	<b>75173</b>

## Features

✓ Heating System:	<b>Central, Natural Gas</b>
✓ Fence:	<b>Wood</b>
✓ Security:	<b>Smoke Detector(s), Carbon Monoxide Detector(s)</b>

## Additional Info

✓ Utilities:	<b>City water, City sewer</b>
✓ Architectural Style:	<b>Traditional</b>

Association Fee:	<b>\$275</b>
Association Fee Frequency:	<b>Semi-Annual</b>

Street:	<b>Burlap</b>
Street Number:	<b>1211</b>
Floor Number:	<b>0</b>
Longitude:	<b>W97° 41' 16.8"</b>
Latitude:	<b>N33° 2' 50.9"</b>

✓ Interior Features:	<b>Cable tv available, Decorative lighting, High speed internet available, Eat-in Kitchen, Kitchen Island, Pantry, Granite Counters, Open Floorplan</b>
----------------------	---

✓ Flooring:	<b>Carpet, Laminate</b>
-------------	-------------------------

High School Name: **Community**

List Agent Full Name: **Bryan Reasor**

List Office Name: **Jeanette Anderson Real Estate**

Matrix Modified DT:

Middle School Name: **Leland Edge**

Parcel Number: **2890965**

✓ Parking Features:	<b>Garage</b>
---------------------	---------------

School District: **Community Isd**

Property Type: **Residential**

✓ Roof:	<b>Composition</b>
---------	--------------------

Status: **Active**

Structural Style: **Single detached**

SQFT Gross: **0 Sqft**

SQFT Lot: **7,448.76 Sqft**

Street Suffix: **Lane**

Number Of Parking Spaces: **0**

Fireplace: **0**

Garage: **0**

Agent [Info](#)

---



Pam Matlock

 <http://pammatlock.com/>

 469-269-0PAM

 pam@pammatlock

