

Single Family Residence For sale

- 4021 Elsa, Celina, Texas 75009

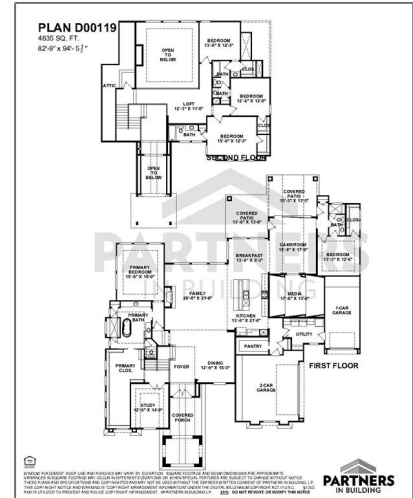

Basic Details

Property Type:	Single Family Residence
Listing Type:	For sale
MLS Number:	20630246
Price:	\$1,565,000
Bedrooms:	5
Bathrooms:	4
Year Built:	2024
Acreage:	43,560 Acre

Address Map

Country:	USA
State:	TX
County:	Collin
City:	Celina
Subdivision:	Harper Estates
Zipcode:	75009

Features

✓ Heating System:	Natural Gas, Fireplace(s), Energy Star Qualified Equipment
✓ Fence:	Fenced, Back Yard
✓ Security:	Fire Alarm, Smoke Detector(s), Prewired, Gated Community

Additional Info

✓ Utilities:	Aerobic septic
✓ Architectural Style:	Traditional

Association Fee: **\$1,000**

Association Fee Frequency: **Annually**

✓ Community	Jogging path/bike path,
-------------	--------------------------------

Street:	Elsa
Street Number:	4021
Floor Number:	0
Longitude:	W97° 11' 47.7"
Latitude:	N33° 17' 25.2"

Features: **Perimeter fencing, Curbs, Gated, Sidewalks**

Elementary School Name: **O'dell**

✓ Exterior Features: **Covered Patio/porch, Rain Gutters**

✓ Interior Features: **Decorative lighting, Loft, Built-in Features, Eat-in Kitchen, Kitchen Island, Pantry, Walk-in Closet(s), Open Floorplan, Double Vanity**

✓ Flooring: **Carpet, Wood, Tile**

High School Name: **Celina**

List Agent Full Name: **Wesley Bryant**

List Office Name: **Partners In Building**

✓ Lot Features: **Acreage, Subdivision, Cleared**

Matrix Modified DT:

Middle School Name: **Jerry & Linda Moore**

Parcel Number: **N/A**

✓ Parking Features: **Garage, Garage Faces Front, Garage Faces Side**

School District: **Celina isd**

Property Type: **Residential**

✓ Roof: **Metal, Composition**

Status: **Active**

Structural Style: **Single detached**

SQFT Gross: **0 Sqft**

SQFT Lot: **43,560 Sqft**

Street Suffix: **Drive**

✓ Fireplace Features: **Living Room, Gas**

Number Of
Parking Spaces: **0**

Fireplace: **1**

Garage: **0**

Agent Info



Pam Matlock

 <http://pammatlock.com/>

 469-269-0PAM

 pam@pammatlock

-
