

# Unimproved Land For sale

- TBD State Hwy 121, Anna, Texas 75409

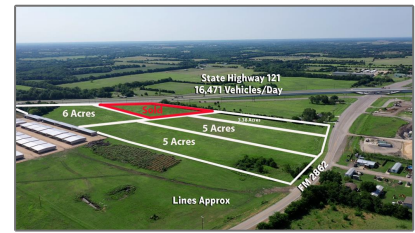

## Basic Details

Property Type:	<b>Unimproved Land</b>
Listing Type:	<b>For sale</b>
MLS Number:	<b>20514549</b>
Price:	<b>\$1,700,000</b>
Acreage:	<b>5 Acre</b>

## Address Map

Country:	<b>USA</b>
State:	<b>TX</b>
County:	<b>Collin</b>
City:	<b>Anna</b>
Subdivision:	<b>SAMUEL CRAFT SURVEY,</b>
Zipcode:	<b>75409</b>
Street:	<b>State Hwy 121</b>
Street Number:	<b>TBD</b>
Floor Number:	<b>0</b>
Longitude:	<b>W97° 27' 6.6"</b>
Latitude:	<b>N33° 21' 3.8"</b>

## Additional Info

✓ Utilities:	<b>Asphalt, All weather road, Co-op water, Overhead utilities, Outside city limits, Other, Unincorporated, No sewer, Co-op Electric, Electricity Available, Cable Available</b>
--------------	---

Association Fee: **\$0**

Elementary School Name: **Joe k bryant**

High School: **Anna**

Name:

List Agent Full **Cindy Green**

Name:

List Office **Coldwell Banker**

Name: **Apex, REALTORS**

Lot Features: **Acreage, Interior lot,  
Pasture, Irregular Lot,  
Many Trees, Cleared**

Matrix Modified

DT:

Middle School **Anna**

Name:

Parcel Number: **R616500101101**

Primary School **Early Childhood**

Name: **Center**

School District: **Anna Isd**

Property Type: **Land**

Status: **Active**

SQFT Gross: **0 Sqft**

SQFT Lot: **217,800 Sqft**

Street Dir Prefix: **NE**

Zoning: **Not Zoned**

Number Of **0**

Parking Spaces:

Fireplace: **0**

Garage: **0**

## Agent **Info**



Pam Matlock

<http://pammatlock.com/>

469-269-0PAM

[pam@pammatlock](mailto:pam@pammatlock)

