

# Office For Rent

199,115 Sqft - 7300 State Highway 121,  
McKinney, Texas 75070

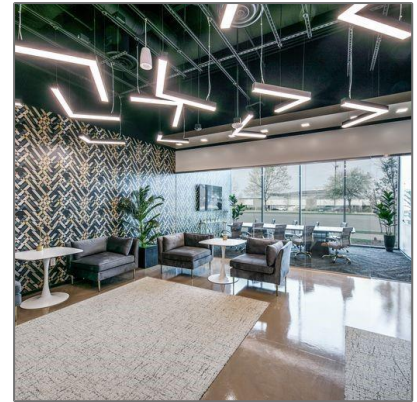

## Basic Details

|                |                     |
|----------------|---------------------|
| Property Type: | <b>Office</b>       |
| Listing Type:  | <b>For Rent</b>     |
| MLS Number:    | <b>20303133</b>     |
| Price:         | <b>\$5,501</b>      |
| Square foot:   | <b>199,115 Sqft</b> |
| Year Built:    | <b>2021</b>         |
| Acreage:       | <b>1.37 Acre</b>    |

## Address Map

|                |                          |
|----------------|--------------------------|
| Country:       | <b>USA</b>               |
| State:         | <b>TX</b>                |
| County:        | <b>Collin</b>            |
| City:          | <b>McKinney</b>          |
| Subdivision:   | <b>District 121 Add</b>  |
| Zipcode:       | <b>75070</b>             |
| Street:        | <b>State Highway 121</b> |
| Street Number: | <b>7300</b>              |
| Postal Code:   | <b>1987</b>              |

## Features

Heating System: **Central**

## Additional Info

Utilities: **City water, City sewer, Other**

Association Fee: **\$0**

Flooring: **Other**

List Agent Full Name: **Edward Wiewel**

List Office Name: **Rohter & Company**

Matrix Modified DT:

Parcel Number: **R1232500A00401**

Floor Number: **0**

Longitude: **W97° 17' 29"**

Latitude: **N33° 8' 4"**

✓ Parking Features: **Other**

Property Type: **Commercial Lease**

✓ Roof: **Other**

Status: **Active**

SQFT Gross: **650 Sqft**

SQFT Lot: **59,502.96 Sqft**

Zoning: **Commercial-Executive Office**

Number Of Parking Spaces: **0**

Fireplace: **0**

Garage: **0**

## Agent Info

---



Pam Matlock

<http://pammatlock.com/>

469-269-0PAM

[pam@pammatlock](mailto:pam@pammatlock)

---